

EC10 Series Integrated Door Controller

About the Product

EC10 Series Integrated Door Controller using closed loop servo control technology, integrate car top control panel and door control as an elevator door system drive controller. It is customized for EC100 / EC160 series elevator integrated controller, which make the debugging and maintain easily.



Technical Features

- Use closed loop servo control technology, due to high velocity response ability
- Integrated car top control board, reducing the wiring, simple and convenient debugging
- Precise of torque control, having door open/ close torque protect function
- Intelligent door width self learning, is easy to use
- Advanced limit function ensure the door machine is running smoothly and accurate
- Friendly parameter setting interface, convenient modify parameter
- Various communication interfaces: Support CAN, MODBUS, RS232

Specification

| Item | Model | Rated Power(W) | Brake(A) | Contactora(A) | Main wiring(mm2) |
|----------------|--------------|----------------|----------|---------------|------------------|
| DoorController | EC10-0R2G-S2 | 200 | 10 | 10 | 2.5 |
| PM Motor | DL120-S16 | 50 | - | - | - |

Dimension

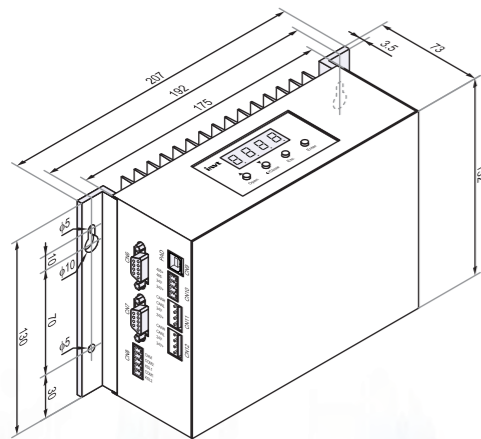

EC10 Integrated Door Controller

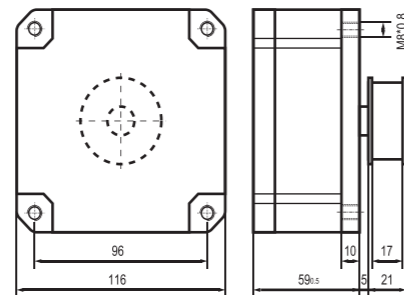

PM Motor

EC20 Series Elevator Door Controller

About the Product

EC20 Series Elevator Door Controller adopts international advanced vector control algorithm, can drive asynchronous motors, supports speed control mode, distance control mode 1 and 2, and it is widely used in automatic doors for elevators, shopping malls and supermarkets.



Technical Features

- **Excellent control performance**
Sensorless vector control and closed loop control for induction door motor
- **Various control modes**
Available speed control mode, distance control mode 1 and 2, improving application range
- **Mini structure design**
Smaller size, saving installation space
- **Various interfaces and strong functions**
Standard embedded CAN communication interface
- **Multiple mounting methods**
Compatible with wall mounting and rail mounting, easy to install
- **Easy to use and maintain**
The fan can be assembled and disassembled separately, easy to maintain

Specification

| Model | Rated output power (W) | Rated input current (A) | Rated output current (A) | Gross weight (Kg) | Dimension (mm) |
|--------------|------------------------|-------------------------|--------------------------|-------------------|----------------|
| EC20-0R4G-S2 | 400 | 6.5 | 2.5 | 1.1 | 215*125*180 |
| EC20-0R7G-S2 | 750 | 9.3 | 4.2 | 1.1 | 215*125*180 |

Dimension

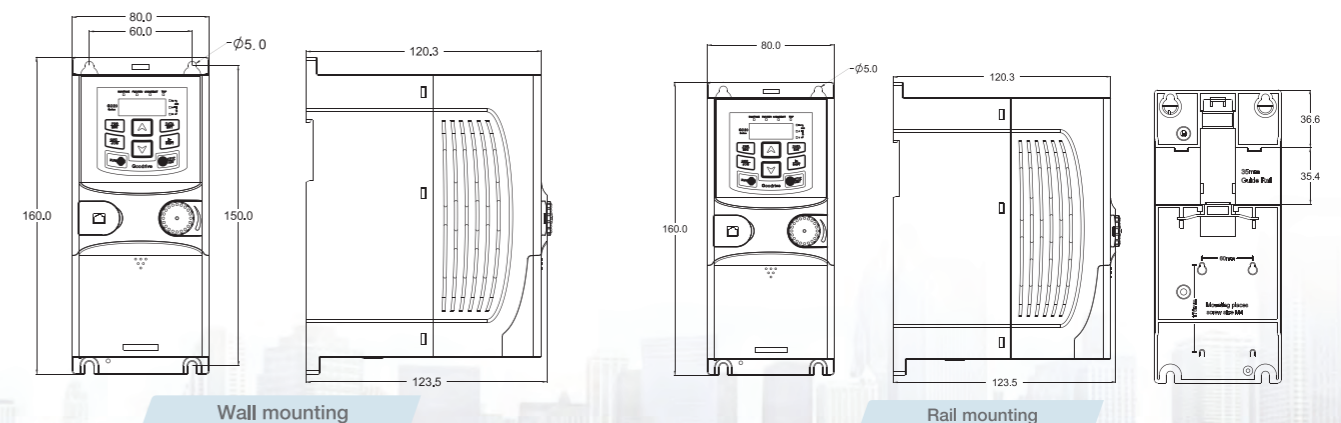

Wall mounting

Rail mounting